

# HEARING NOTICE

## PROPOSED CHANGES TO VOTING DISTRICTS

THE PHILADELPHIA COUNTY BOARD OF ELECTIONS  
HAS PETITIONED THE COURT OF COMMON PLEAS TO  
ALTER AND REVISE THE BOUNDARIES OF THE  
FOLLOWING ELECTION DISTRICTS

**WARD: 30<sup>TH</sup>**

**DIVISIONS: 1<sup>ST</sup> & 7<sup>TH</sup>**

IN ACCORDANCE WITH THE ATTACHED PLAN, A HEARING  
IS SCHEDULED FOR THIS PETITION AS FOLLOWS:

**HEARING DATE: AUGUST 1, 2019**

**TIME: 9:30 A.M.**

**PLACE: CITY HALL COURTROOM 513**

ANY PERSONS OBJECTING TO THESE CHANGES MUST  
FILE THOSE OBJECTIONS WITH THE COURT OF  
COMMON PLEAS PRIOR TO THE DATE OF THE HEARING

THESE DIVISIONS HAVE THE FOLLOWING NUMBERS OF ELECTORS  
ENROLLED:

30-01 (1,173); 30-07 (1,258)

OFFICE OF THE CITY COMMISSIONERS  
COUNTY BOARD OF ELECTIONS  
215-686-3469

0003 RULE ISSUED

IN THE COURT OF COMMON PLEAS  
CIVIL TRIAL DIVISION OF PHILADELPHIA COUNTY

Filed and Attested by the  
Office of Judicial Records  
09 JUL 2019 03:19 pm

-----  
IN RE PETITION OF PHILADELPHIA  
COUNTY BOARD OF ELECTIONS

-----  
IN THE COURT OF COMMON PLEAS  
OF PHILADELPHIA COUNTY

July Term, 2019

NO. 21715

**RULE TO SHOW CAUSE**

AND NOW, this 17 day of July, 2019, upon consideration of the Petition to redraw, revise and modify the Election District boundaries of the 1<sup>st</sup> and 7<sup>th</sup> Election Districts of the 30<sup>th</sup> Ward and create the 18<sup>th</sup> Election District of the 30<sup>th</sup> Ward filed by the Philadelphia County Board of Elections, pursuant to the Pennsylvania Election Code, 25 P.S. § 2704, a Rule is issued upon all interested parties to appear and show cause why an Order should not be entered authorizing the modification and revisions requested within that Petition.

This Rule is Returnable on the 1 day of August 2019, at 1:30 A.M./P.M. in Courtroom 513, City Hall, Philadelphia, Pennsylvania.

On the Return dates, Petitioner shall provide an Affidavit of Service certifying that notice has been provided by mail or hand delivery to the Democratic and Republican Ward Leaders, Committee People, and the Election Boards, and by posting for the public at large. The notice shall include a brief statement of the division, re-division, alteration, formation or consolidation of Elections Districts recommended by the Philadelphia County Board of Elections, and the date upon which argument will be considered by this Court, along with a warning that any person objecting thereto must file written objections with the Office of Judicial Records at least 24 hours before the hearing date. Such notice must be posted for at least ten (10) days, in at least five (5) public and conspicuous places in the district or districts to be affected thereby; and at least one such notice shall be posted on or in the immediate vicinity of the polling place in the district.

Philadelphia Board Of Elections Vs Philadelphia R: FIS



BY THE COURT

IN THE COURT OF COMMON PLEAS  
CIVIL TRIAL DIVISION OF PHILADELPHIA COUNTY

Filed and Attested by the  
Office of Judicial Records  
09 JUL 2019 03:19 pm

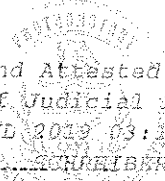

-----  
IN RE PETITION OF PHILADELPHIA  
COUNTY BOARD OF ELECTIONS

-----  
IN THE COURT OF COMMON PLEAS  
OF PHILADELPHIA COUNTY

July Term, 2019

NO. 01715

**ORDER**

AND NOW, this \_\_\_\_\_ day of \_\_\_\_\_, 2019, upon consideration of this Petition, filed on \_\_\_\_\_ day of \_\_\_\_\_ 2019, the hearing held on the \_\_\_\_\_ day of \_\_\_\_\_, 2019, where compliance with this Court's Rule to Show Cause having been established by Affidavit of Service certifying that notice was provided as required, and there being no objection,

IT IS HEREBY ORDERED, ADJUDGED and DECREED that the Petition to redraw, revise and modify the Election District boundaries of the 1<sup>st</sup> and 7<sup>th</sup> Election Districts of the 30<sup>th</sup> Ward and create the 18<sup>th</sup> Election District of the 30<sup>th</sup> Ward, filed by the Philadelphia County Board of Elections, pursuant to the Pennsylvania Election Code, 25 P.S. § 2704, is GRANTED, and that the boundary modifications and revisions of the 1<sup>st</sup> and 7<sup>th</sup> Election Districts of the 30<sup>th</sup> Ward be modified and revised and the creation of the 18<sup>th</sup> Election District of the 30<sup>th</sup> Ward be created, as per the Chart and attachments hereto.

BY THE COURT

\_\_\_\_\_

**CITY OF PHILADELPHIA LAW DEPARTMENT**  
MARCEL S. PRATT, CITY SOLICITOR  
BY: Benjamin H. Field, Divisional Deputy City Solicitor  
Attorney I.D. No. 204569  
Michael Pfautz, Assistant City Solicitor  
Attorney I.D. No. 325323  
One Parkway Building, 15<sup>th</sup> Floor  
1515 Arch Street  
Philadelphia, PA 19102-1595  
Tel (215) 683-5024 and Fax (215) 683-5299

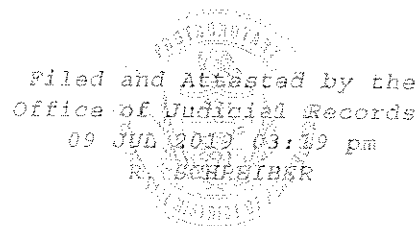

*Attorneys for Petitioner*

-----  
IN RE PETITION OF PHILADELPHIA  
COUNTY BOARD OF ELECTIONS

-----  
IN THE COURT OF COMMON PLEAS  
OF PHILADELPHIA COUNTY

July Term, 2019  
NO. 01715

---

**PETITION TO REDRAW, REVISE AND MODIFY THE ELECTION DISTRICT  
BOUNDARIES OF THE 1<sup>ST</sup> AND 7<sup>TH</sup> ELECTION DISTRICTS OF THE 30<sup>TH</sup> WARD  
AND CREATE THE 18<sup>TH</sup> ELECTION DISTRICT OF THE 30<sup>TH</sup> WARD**

Petitioner, the Philadelphia County Board of Elections, by and through its undersigned counsel, in accordance with 25 P.S. § 2704, petitions this Court for an order to redraw, revise, and modify the boundaries of the 1<sup>st</sup> and 7<sup>th</sup> Election Districts of the 30<sup>th</sup> Ward and create the 18<sup>th</sup> Election District of the 30<sup>th</sup> Ward as set forth below:

1. The 1<sup>st</sup> and 7<sup>th</sup> Election Districts of the 30<sup>th</sup> Ward are located at the northeastern part of the 30<sup>th</sup> Ward.
2. The 1<sup>st</sup> Election District of the 30<sup>th</sup> Ward is bounded by Fitzwater Street, 18<sup>th</sup> Street, South Street, and 15<sup>th</sup> Street. *See* Exhibit A at 1-2.
3. The 7<sup>th</sup> Election District of the 30<sup>th</sup> Ward is bounded by Bainbridge Street, 21<sup>st</sup> Street, Tryon Street, 22<sup>nd</sup> Street, Lombard Street, and 18<sup>th</sup> Street. *See* Exhibit A at 3-4.

4. During the 2019 Municipal Primary and Special Election, the 1<sup>st</sup> Election District of the 30<sup>th</sup> Ward voted at Gideon Hall at Scottish Rite House located at 1525 Fitzwater Street.

5. During the 2019 Municipal Primary and Special Election, the 7<sup>th</sup> Election District of the 30<sup>th</sup> Ward voted at Penn Medicine at Rittenhouse located at 1800 Lombard Street.

6. An influx of recent residential construction in these election districts has created an unusually high number of registered electors.

7. The 1<sup>st</sup> Election District of the 30<sup>th</sup> Ward has 1,173 electors.

8. The 7<sup>th</sup> Election District of the 30<sup>th</sup> Ward has 1,258 electors.

9. This high number of electors creates long waiting times at the polls on Election Day, an unnecessary burden to the electors.

10. According to the Pennsylvania Election Code, “[t]he county board of elections may . . . petition the court for the division or redivision of any . . . ward or election district into two or more election districts, or for the alteration of the bounds of any election district, or for the formation of one or more election districts out of two or more existing election districts, or parts thereof.” 25 P.S. § 2704.

11. The petition must include “a map and a verbal description of the boundaries of the proposed new election districts” and “a certification of the number of electors registered in each of the resulting election districts for the immediately preceding general or municipal election.” *Id.*

12. “Upon the presentation of any such petition by the county board, the court may make such order for the division, redivision, alteration, formation or consolidation of election districts, as will, in its opinion, promote the convenience of electors and the public interests: Provided [sufficient notice is provided].” *Id.*

13. Dividing the aforementioned election districts will alleviate unnecessary burdens for these electors.

14. The proposed modification for the 1<sup>st</sup> Election District of the 30<sup>th</sup> Ward will consist of the following new boundaries: Fitzwater Street, Chadwick Street, Bainbridge Street, 17<sup>th</sup> Street, South Street, and 15<sup>th</sup> Street. *See Exhibits B, C.*

15. The proposed modification for the 7<sup>th</sup> Election District of the 30<sup>th</sup> Ward will consist of the following new boundaries: Bainbridge Street, 21<sup>st</sup> Street, Tryon Street, 22<sup>nd</sup> Street, Lombard Street, 20<sup>th</sup> Street, South Street, and 19<sup>th</sup> Street. *See Exhibits B, D.*

16. The proposed creation of the 18<sup>th</sup> Election District of the 30<sup>th</sup> Ward will consist of the following new boundaries: Fitzwater Street, 18<sup>th</sup> Street, Bainbridge Street, 19<sup>th</sup> Street, South Street, 20<sup>th</sup> Street, Lombard Street, 18<sup>th</sup> Street, South Street, 17<sup>th</sup> Street, Bainbridge Street, and Chadwick Street. *See Exhibits B, E.*

17. The tentative polling place location for the electors of the proposed 1<sup>st</sup> Election District of the 30<sup>th</sup> Ward will be Gideon Hall at Scottish Rite House located at 1525 Fitzwater Street.

18. The tentative polling place location for the electors of the proposed 7<sup>th</sup> Election District of the 30<sup>th</sup> Ward will be the Philadelphia School located at 2501 Lombard Street.

19. The tentative polling place location for the electors of the proposed 18<sup>th</sup> Election District of the 30<sup>th</sup> Ward will be Penn Medicine at Rittenhouse located at 1800 Lombard Street.

**WHEREFORE**, the Philadelphia County Board of Elections request the Court to revise, redraw, and modify the Election District boundaries of the 1<sup>st</sup> and 7<sup>th</sup> Election Districts of the 30<sup>th</sup> Ward and create the 18<sup>th</sup> Election District of the 30<sup>th</sup> Ward, according to the attached plan.

Respectfully submitted,

CITY OF PHILADELPHIA  
LAW DEPARTMENT

DATED: July 9, 2019

BY: /s/ Benjamin H. Field  
Divisional Deputy City Solicitor  
Attorney I.D. No. 204569  
Michael Pfautz, Assistant City Solicitor  
Attorney I.D. No. 325323  
1515 Arch Street, 15th Floor  
Philadelphia, PA 19102  
Phone: (215) 683-5024  
Fax: (215) 683-5069  
[Benjamin.Field@phila.gov](mailto:Benjamin.Field@phila.gov)  
*Attorneys for Petitioner*

**VERIFICATION**

I, Garrett C. Dietz, for the Office of the City Commissioners, verify that the facts as set forth above are true and correct to the best of my knowledge, information and belief.

I understand that false statements made therein are subject to the penalties of 18 Pa. C.S. § 4904, relating to unsworn falsification to authorities.

DATED: July 5, 2019

BY:   
Garrett C. Dietz  
Election Compliance Specialist  
Office of the City Commissioners



Filed and Attested by the  
Office of Judicial Records  
09 JUL 2013 03:49 pm

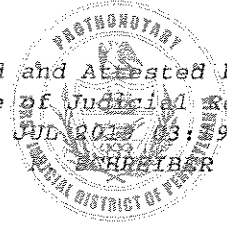

# EXHIBIT "A"

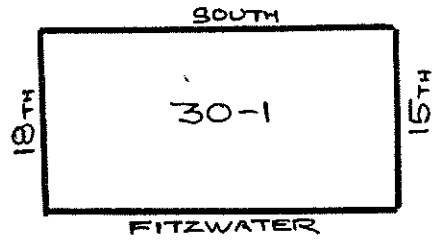

11

The new 1st Election District of the 30th Ward is bound and described as follows:

BEGINNING at the intersection of the middle line of 15th St. and the middle line of South St.; thence southward along the middle line of 15th St. to the middle line of Fitzwater St.; thence westward along the middle line of Fitzwater St. to the middle line of 18th St.; thence northward along the middle line of 18th St. to the middle line of South St.; thence eastward along the middle line of South St. to the middle line of 15th St. to the first point and beginning.

The new 1st Election District of the 30th Ward will have approximately 769 electors.

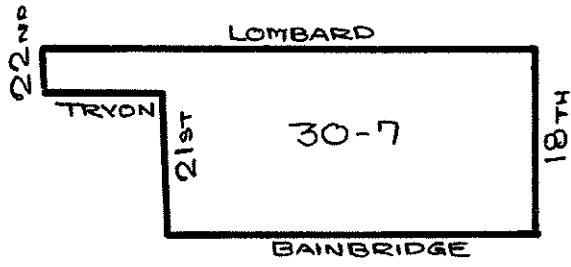

The new 7th Election Division of the 30th Ward is bounded and described as follows:

BEGINNING at the intersection of the middle line of 22nd St. and the middle line of Lombard St.; thence southward along the middle line of 22nd St. to the middle line of Tryon St.; thence eastward along the middle line of Tryon St. to the middle line of 21st St.; thence southward along the middle line of 21st St. to the middle line of Bainbridge St.; thence eastward along the middle line of Bainbridge St. to the middle line of 18th St.; thence northward along the middle line of 18th St. to the middle line of Lombard St.; thence westward along the middle line of Lombard St. to the middle line of 22nd St. to the first point and beginning.

The new 7th Election District of the 30th Ward will have approximately 677 electors.

# EXHIBIT “B”

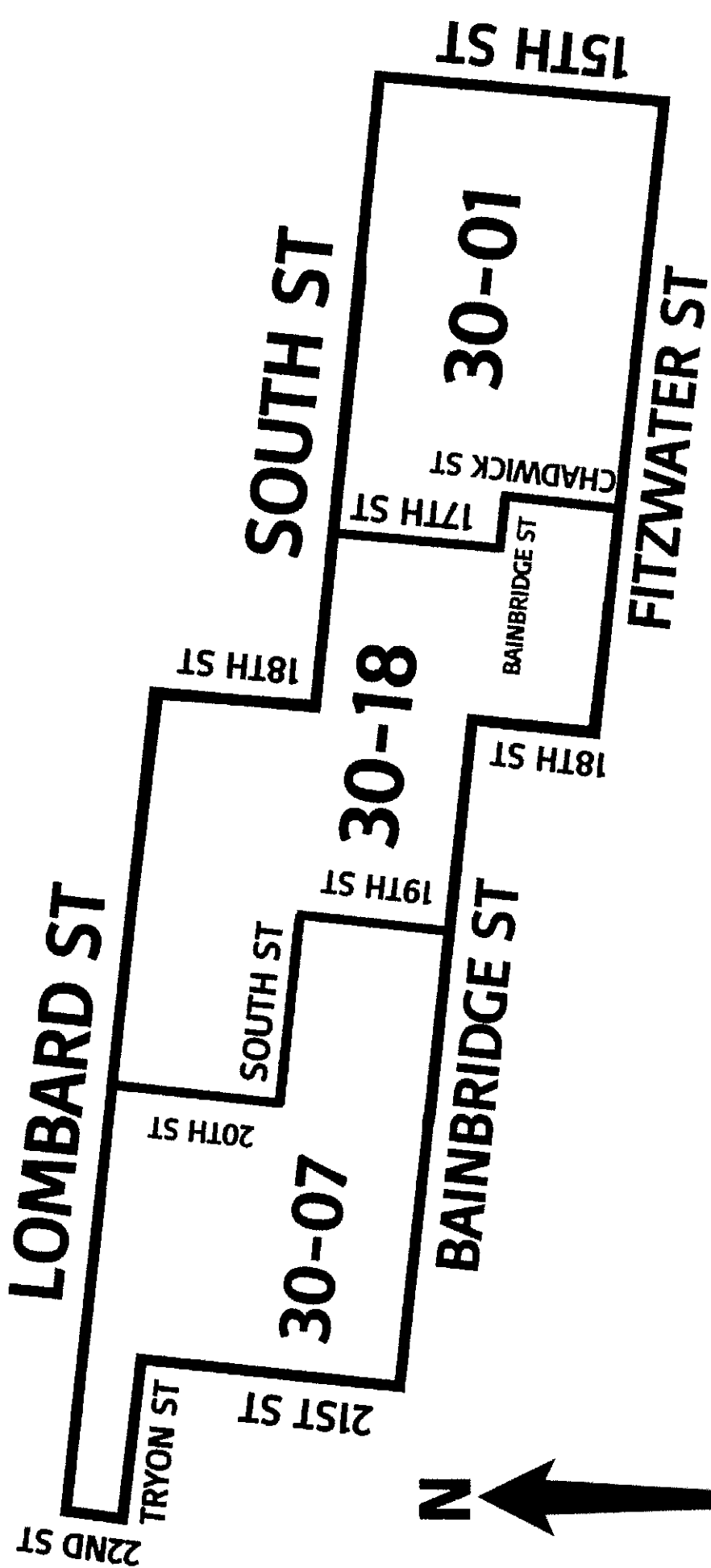

# EXHIBIT “C”



The new 1<sup>st</sup> Election District of the 30<sup>th</sup> Ward is bounded and described as follows:

Beginning at the intersection of the middle line of 15<sup>th</sup> Street and the middle line of South Street; thence southward along the middle line of 15<sup>th</sup> Street to the middle line of Fitzwater Street; thence westward along the middle line of Fitzwater Street to the middle line of Chadwick Street; thence northward along the middle line of Chadwick Street to the middle line of Bainbridge Street; thence westward along the middle line of Bainbridge Street to the middle line of 17<sup>th</sup> Street; thence northward along the middle line of 17<sup>th</sup> Street to the middle line of South Street; thence eastward along the middle line of South Street to the middle line of 15<sup>th</sup> Street, the first point and beginning.

**PROPOSED WRITTEN DESCRIPTION**

# EXHIBIT “D”

The new 7<sup>th</sup> Election District of the 30<sup>th</sup> Ward is bounded and described as follows:

Beginning at the intersection of the middle line of 22<sup>nd</sup> Street and the middle line of Lombard Street; thence southward along the middle line of 22<sup>nd</sup> Street to the middle line of Tryon Street; thence eastward along the middle line of Tryon Street to the middle line of 21<sup>st</sup> Street; thence southward along the middle line of 21<sup>st</sup> Street to the middle line of Bainbridge Street; thence eastward along the middle line of Bainbridge Street to the middle line of 19<sup>th</sup> Street; thence northward along the middle line of 19<sup>th</sup> Street to the middle line of South Street; thence westward along the middle line of South Street to the middle line of 20<sup>th</sup> Street; thence northward along the middle line of 20<sup>th</sup> Street to the middle line of Lombard Street; thence westward along the middle line of Lombard Street to the middle line of 22<sup>nd</sup> Street, the first point and beginning.

**PROPOSED WRITTEN DESCRIPTION**

# EXHIBIT “E”

The new 18<sup>th</sup> Election District of the 30<sup>th</sup> Ward is bounded and described as follows:

Beginning at the intersection of the middle line of Chadwick Street and the middle line of Fitzwater Street; thence westward along the middle line of Fitzwater Street to the middle line of 18<sup>th</sup> Street; thence northward along the middle line of 18<sup>th</sup> Street to the middle line of Bainbridge Street; thence westward along the middle line of Bainbridge Street to the middle line of 19<sup>th</sup> Street; thence northward along the middle line of 19<sup>th</sup> Street to the middle line of South Street; thence westward along the middle line of South Street to the middle line of 20<sup>th</sup> Street; thence northward along the middle line of 20<sup>th</sup> Street to the middle line of Lombard Street; thence eastward along the middle line of Lombard Street to the middle line of 18<sup>th</sup> Street; thence southward along the middle line of 18<sup>th</sup> Street to the middle line of South Street; thence eastward along the middle line of South Street to the middle line of 17<sup>th</sup> Street; thence southward along the middle line of 17<sup>th</sup> Street to the middle line of Bainbridge Street; thence eastward along the middle line of Bainbridge Street to the middle line of Chadwick Street; thence southward along the middle line of Chadwick Street to the middle line of Fitzwater Street, the first point and beginning.

**PROPOSED WRITTEN DESCRIPTION**